

REV.	DATE	ECN NO.	MODIFICATION	APPROVER
A	2009/11/17	/	NEW	Vicky

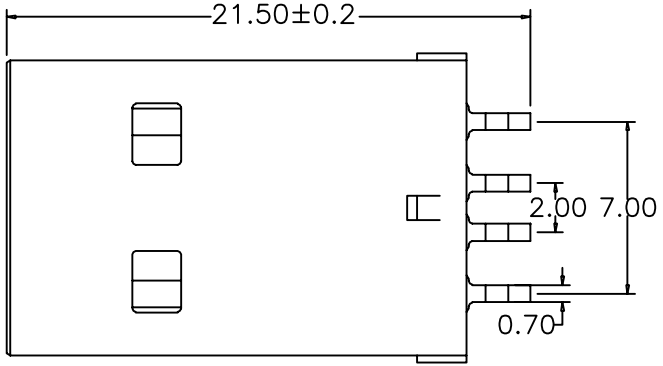

Specifications:
 Electrical:
 1.Current Rating: 1.5A/contact terminal
 2.Voltage Rating: 30V DC
 3.Contact Resistance: 30 milliohms MAX
 4.Dielectric Withstanding Voltage:
 500V AC AT Sea Level
 5.Insulation Resistance:
 1000MEGA ohms MIN

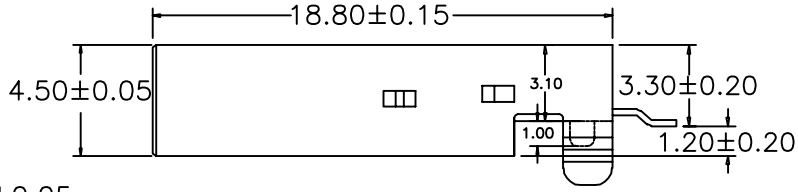
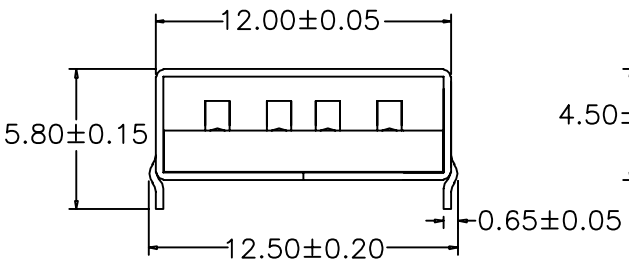

Mechanical:
 1.Mate Force: 3.75kgf(MAX)
 2.Unmate Force: 1.02kgf(MIN)
 3.Terminal Retention: 1.2kgf(MIN)
 Material:
 1.Housing: HIGH TEMP. PLASTIC,UL94V-0
 PBT/LCP, White/Black
 2.Contact: Copper Alloy C2680
 3.Shell:C2680/SPCC
 Finish:
 1.Contact: Plated Gold in Mating Area;
 Tin on Solder Tails
 2.Shell: Nickel Plating

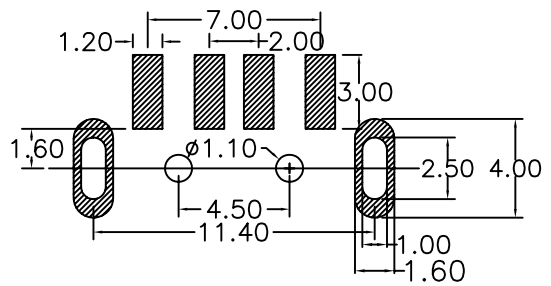

PCB LAYOUT

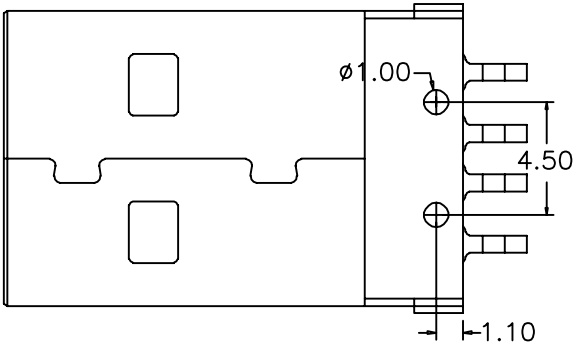

GENERAL TOLERANCE			UNITS	NAME:	USB		
SELECT	✓		mm	PART NO:	USB304MA-C1005***		
ON.	TOL.	1 2 3	MAT'L	TITLE:	USB A/M 4P SMT		
X.XXX	±0.10	±0.05 ±0.15	FINISH	APPD:	Vicky		
X.XX	±0.20	±0.13 ±0.25		CHKD:	lvy		
X.X	±0.30	±0.25 ±0.50	Q'TY	DR:	Anna		
X.		±0.38 ±1.00				SCALE	SHEET
ANGLE					1:1	1/1	A