

0.039" X 0.039"(1.0mm X 1.0mm) Female Header

Dual Row 06 to 100 contacts

Thru-Hole Type Profile: 2.05mm

APPLICATION AND FEATURES

Standoffs facilitate post solder cleaning.
Mates with:L120,L121

SPECIFICATION

Current Rating: 1 Amps
Insulator Resistance: 1000 Megohms min
Dielectric Withstanding: AC 500 V
Operating Temperature: - 40° ~ +105° C
Contact Material: Copper Alloy
Insulator Material: Polyester,UL 94V-0
Finish: Tin,Gold Plated
Standard: Gold Flash all over

Ordering Information

L221 : Product Series
|
S : Connector Type (Straight Type)
|
X X : Number of Contacts
No. of Contacts = Code
06 thru 100
|
X : Plated Option
1: Full Tin
2: Gold Flash
3: Gold 5u"
4: Gold 10u"
5: Gold 15u"
6: Gold 30u"
7: Option
(Standard: 2)
|
B : Solder Height
For example:
B= 1.8
Please write out the code.

18

Unit: mm

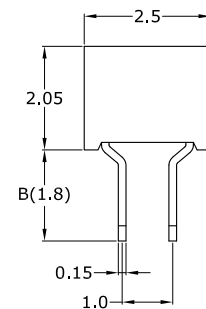
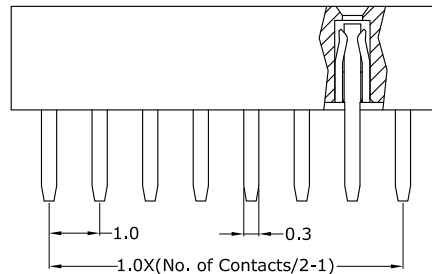
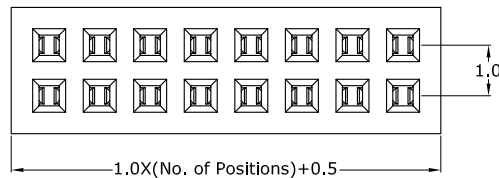
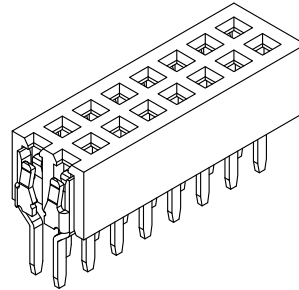

Recommended P.C Board Hole Layout

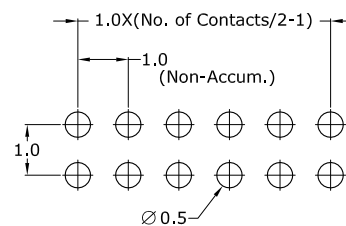

Products specifications are subject to be changed without notice
Please contact sales office for further confirmation.