

0.1" X 0.1"(2.54mm X 2.54mm) Female Header

Dual Row 04 to 80 Contacts

Thru-Hole Type Profile: 7.1/8.5mm

APPLICATION AND FEATURES

For profile application 7.1mm,8.5mm height.
Mates with:S120,S121,S122,S124,S125

SPECIFICATION

Current Rating: 3 Amps
Insulator Resistance: 5000 Megohms min
Dielectric Withstanding: AC 1000 V
Operating Temperature: - 40° ~ +105° C
Contact Material: Copper Alloy
Insulator Material: Polyester,UL 94V-0
Finish: Tin,Gold Plated
Standard: Gold Flash all over

Ordering Information

S223 : Product Series
S : Connector Type (Straight Type)
X X : Number of Contacts
No. of Contacts = Code
04 thru 80
X : Plated Option
1: Full Tin
2: Gold Flash
3: Gold 5u"
4: Gold 10u"
5: Gold 15u"
6: Gold 30u"
7: Option
(Standard: 2)
H : Body Height
For example:
H= 7.1
Please write out the code.

71

Unit: mm

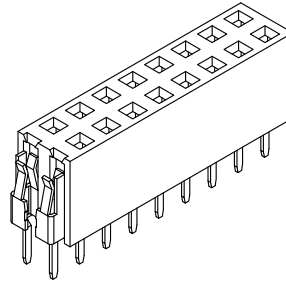

H = { 7.1
8.5

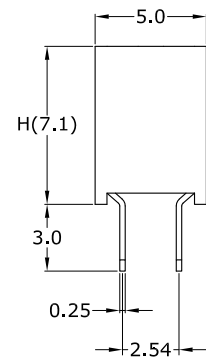
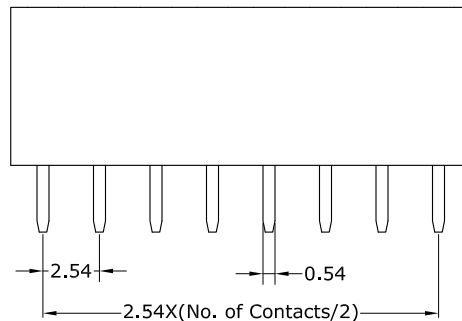
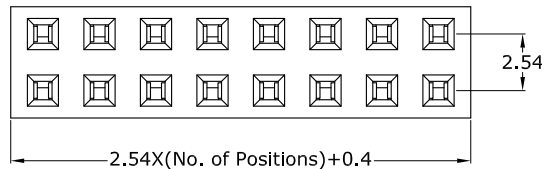

Recommended P.C Board Hole Layout

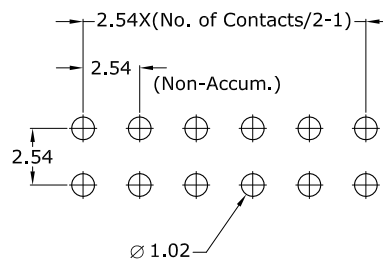

Products specifications are subject to be changed without notice
Please contact sales office for further confirmation.