

ACAD GENERATED DRAWING. DON'T CHANGE BY HAND

REV	DATE	ECN NO.	MODIFICATION	APPROVER
C	2012/06/29	RD00312062901	应业务要求, 新增一种焊脚长度规格	Jason
D	2013/06/18	RD00313061801	重新整理图面	Jason
E	2014/04/23	RD00314042301	插卡状态尺寸变更	Jason

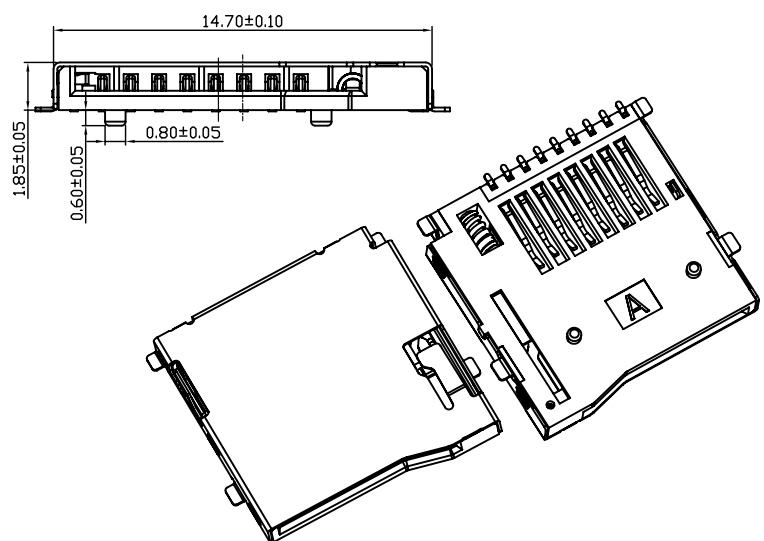
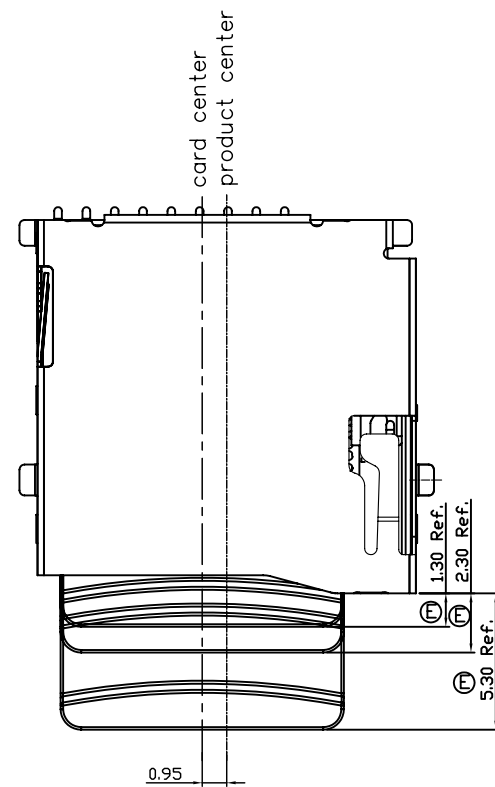
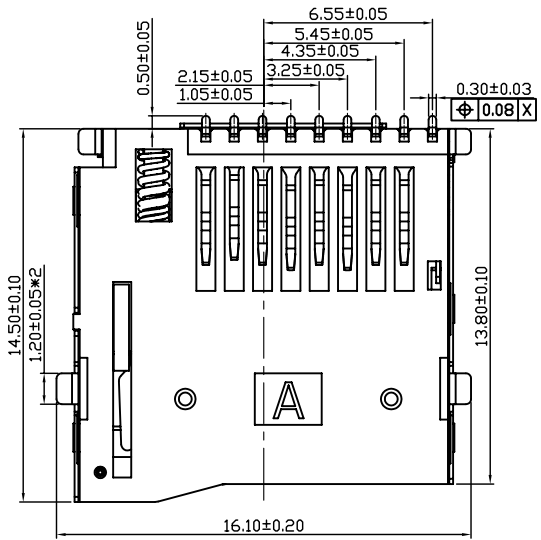
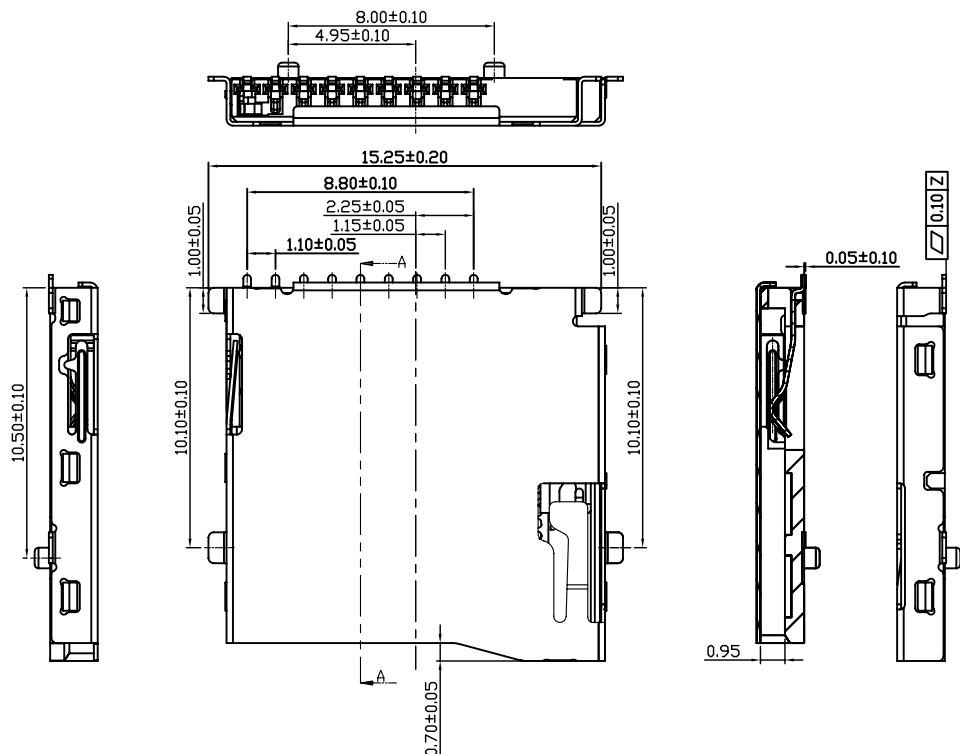

GENERAL TOLERANCE				UNITS	NAME:		
SELECT	✓			mm	Micro sd push conn.		
DN.	TOL	1	2	3	PART NO:		TITLE:
X.XXX	±0.10	±0.05	±0.15		MR01A-01***		Micro sd push conn.(外焊型)
X.XX	±0.15	±0.13	±0.25		APPD: Peter		DWG NO. ATOM-A03302
X.X	±0.20	±0.25	±0.5		CHKD: Jason		SCALE SHEET REV
X.	±0.30	±0.38	±1.00		DR: xh		1:1 1/2 E
ANGLE	±2°						

ACAD GENERATED DRAWING. DON'T CHANGE BY HAND

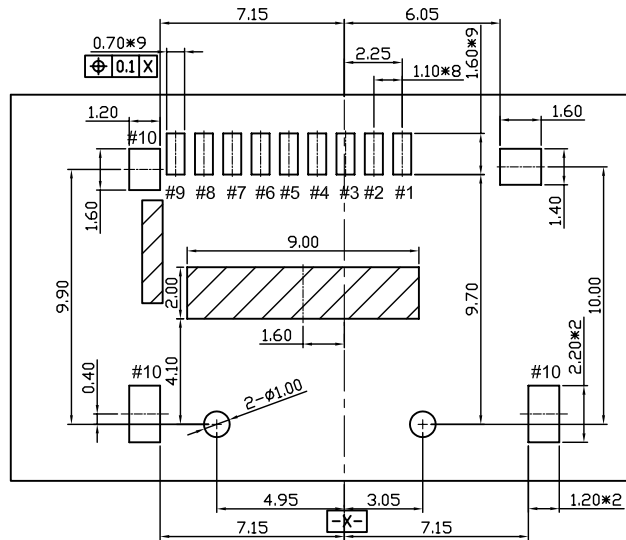

RECOMMENDED PCB LAYOUT
(ALL TOLERANCE ARE ± 0.05)

:PROHIBITION AREA

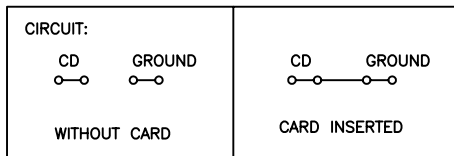

Pin No.	MICRO SD
PIN1	DAT2 1P
PIN2	CD/DAT3 2P
PIN3	CMD 3P
PIN4	VDD 4P
PIN5	CLK 5P
PIN6	VSS 6P
PIN7	DAT0 7P
PIN8	DAT1 8P
PIN9	CARD DETECT
PIN10	GROUND

SPECIFICATION

1.Material:

housing: LCP, UL94V-0,color:black.
orbit: PA46, UL94V-0,color:black.
Contacts: Phosphor Bronze,
Tin 160u" at Solder Tail,
Selected Gold on Contact Area Plating.
Shell: Stainless. Pickling

2.Electrical Characteristics:

Operating voltage : 10V AC(rms)/DC.
Current rating : 0.5 A.
Operating Temperature: $-25^{\circ}\text{C}\sim+85^{\circ}\text{C}$.
Insulation resistance: 1000M ohms min. at 250VDC
Dielectric withstanding voltage:500 VAC/1minute.
Contact resistance: 100m ohms max.

3.Mechanical characteristics

- 3.1 Mating durability:10000 cycles.
- 3.2 Insertion force: 30N Max.
- 3.3 Extraction force: 1~30N
- 3.4 Mating cycle: 10000 cycles at the speed rate of 400-600 cycles/h; Without distortion of plastic and serious wear and tear in terminal, No signal break.

GENERAL TOLERANCE				UNITS	NAME: Micro sd push conn.										
SELECT	✓			mm	PART NO: MRO1A-01***		TITLE: Micro sd push conn.(外型)								
DN.	TOL	1	2	3	APPD: Peter		DWG NO. ATOM-A03302								
X.XXX		± 0.10	± 0.05	± 0.15	CHKD: Jason		<table border="1"> <tr> <td>SCALE</td> <td>SHEET</td> <td>REV</td> </tr> <tr> <td>1:1</td> <td>2/2</td> <td>E</td> </tr> </table>			SCALE	SHEET	REV	1:1	2/2	E
SCALE	SHEET	REV													
1:1	2/2	E													
X.XX		± 0.15	± 0.13	± 0.25	Q'TY										
X.X		± 0.20	± 0.25	± 0.5											
X.		± 0.30	± 0.38	± 1.00											
ANGLE		$\pm 2^{\circ}$													
					DR: xh										